



Remote Control Features & Functions



(78) Symphony Solo Series Remote Control

USERS GUIDE

YMGI Group

601 Arrow Ln, O'Fallon, MO 63366 • info@ymgigroup.com • ymgigroup.com • 866-833-3138

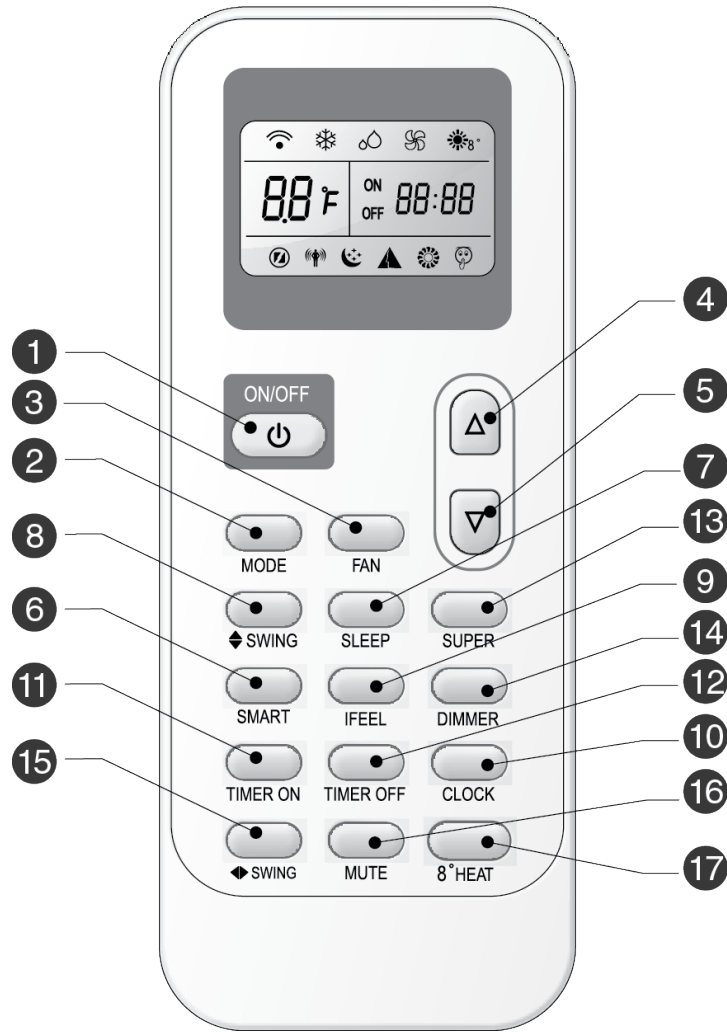

Indication symbols

- | | | | | |
|-------------------|---------------------|--------------------|----------------------|--|
| Cooling indicator | Dry indicator | Fan only indicator | 8° Heating indicator | Heating indicator |
| Auto fan speed | Higher fan speed | High fan speed | Medium fan speed | Low fan speed |
| Lower fan speed | Sleep 1 indicator | Sleep 2 indicator | Sleep 3 indicator | Sleep 4 indicator |
| Smart indicator | Super indicator | Mute indicator | Signal transmit | ON Display set timer
OFF Display current time |
| I feel | Display temperature | | | |

Remote Control Buttons



No.	Name		Function
1	ON/OFF		Unit can be powered on or off.
2	MODE		Button allows you to select the operating mode.
3	FAN		Set fan speed. Available settings sequence is: Auto, Highest, High, Medium, Low, Lowest
4	INCREASE		INCREASE Set Temperature
5	DECREASE		DECREASE Set Temperature
6	SMART MODE		Used to enter fuzzy logic operation directly, regardless of whether the unit is on or off.
7	SLEEP		Used to set or cancel SLEEP mode
8	SWING		Used to start or stop the vertical adjustment of the louver. You can set the airflow direction up or down.
9	I FEEL		In I FEEL mode, the air conditioner operates based on the temperature sensor on the remote control instead of the machine, to keep your current location at the temperature you are comfortable at.
10	CLOCK		Used to set the current time.
11	TIMER ON		Used to set the timed start function.
12	TIMER OFF		Used to set the timed shut down function.
13	SUPER BUTTON		Used to start or stop the Fast Cooling/Heating function. Fast Cooling operates at High fan speed with an automatically set temperature of 61°F (16°C). Fast Heating operates at the Auto fan speed with an automatically set temperature of 86°F (30°C).
14	DIMMER		Pressing this button will turn off all of the displays on the Indoor Unit. Press the button again to turn the display back on.
15	SWING		Used to start or stop the horizontal adjustment of the louver. You can set the airflow direction left or right.
16	MUTE		Used to turn on and off the Mute operation. Fan speed is automatically set to Low.
17	8° HEAT		Set the 8° heating mode.



Remote Controller

Using the Remote Controller

To operate the air conditioner, aim the remote controller at the signal receptor on the Indoor Unit. The remote controller can be used at a distance of 23 ft. (7m).

For best signal transmission between the remote controller and Indoor Unit, keep the signal receiver away from the following:

- Direct sunlight, or other powerful lights or heat sources
- Flat panel television screens, or other electronic appliances that may react to the remote controller.

Additionally, the air conditioner will not operate if curtains, doors, or other items block the signal from the remote controller to the Indoor Unit. If the signal cannot be transmitted properly, either move the item(s) blocking the signal or consult your local dealer.

How to Insert Batteries

- Remove the battery cover according to the arrow direction.
- Insert new batteries, making sure that the (+) and (-) poles of the batteries are matched correctly.
- Slide the cover back into position

Notes:

- Use 2 LR03 AAA (1.5v) batteries.
- Do not use rechargeable batteries.
- When the display becomes dim, you will need to replace the batteries.
- When replacing batteries, use new batteries of the same type.

Optional Remote Controller Cradle

The remote controller may be stored in a (optional) wall mounted cradle. The wall mounted cradle can be purchased separately.

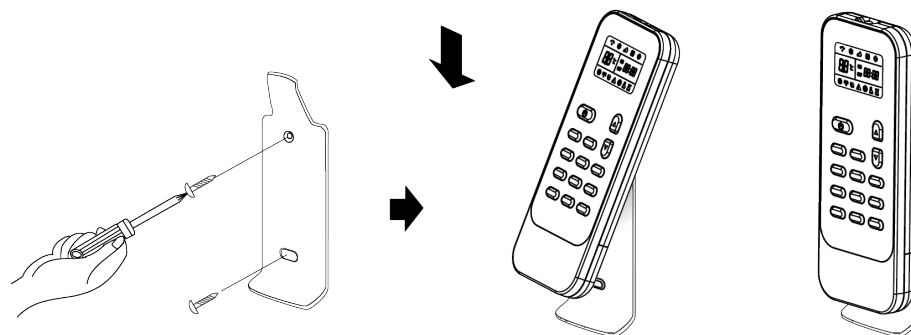
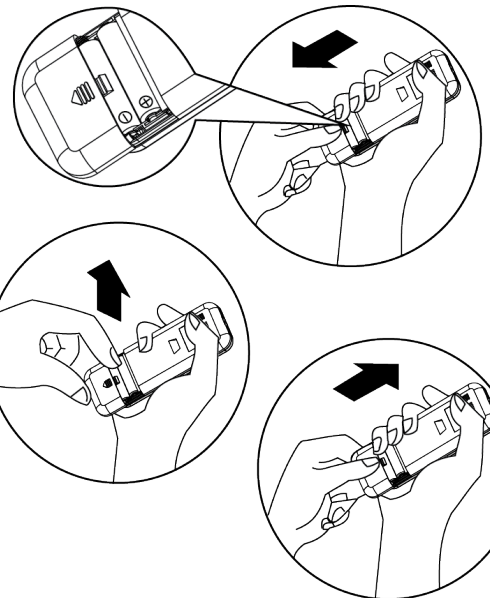
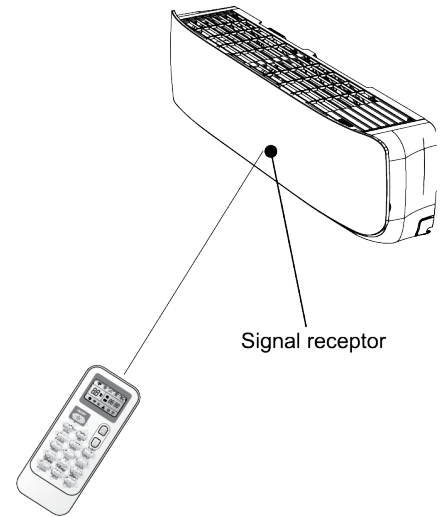

Remote Controller

Turning On

 Press once to turn the system on or off. Indoor Unit Display will light up when On.

Notes:

- During operation, a unit may take a few moments to switch modes. Wait at least 3 minutes between Mode changes.
- In HEAT Mode, the unit will not blow air when powered on. Preheating can take 2-5 minutes before the unit begin blowing warm air.
- When restarting the unit, wait 3 minutes for it to resume operation.

Selecting Mode

Each time MODE button is pressed, the operation mode is changed in the following sequence:



Heating mode is NOT available for cooling only air conditioners.

Fan Mode

Each time the FAN button is pressed, the fan speed is changed it the following sequence:



- In FAN ONLY mode, AUTO is not available.
- In DRY mode, fan speed is set to AUTO automatically. FAN button is not adjustable in DRY mode.

Setting Temperature

 Press once to raise the set temperature 1°F (1°C)

 Press once to lower the set temperature 1°F (1°C)

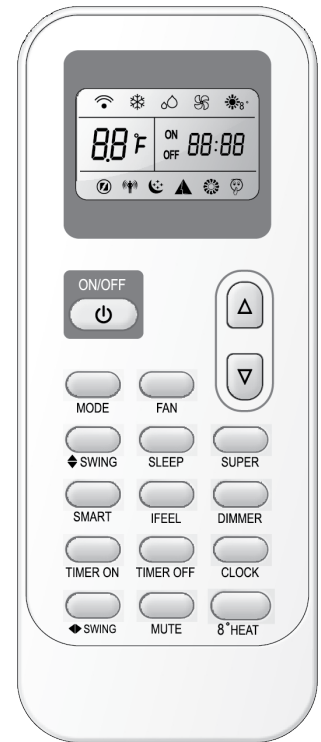

Available Temperature Ranges	
Mode	Range
HEATING, COOLING	61°F ~ 86°F (16°C-30°C)
DRY (Dehumidify)	-7°F ~7°F
FAN	Not Available

Notes:

- Press and hold MODE and  for 3 seconds to change temperature display between °F to °C
- HEATING Mode is not available on Cooling Only models.
- In DRY Mode, the unit can decrease or increase 7 °F above or below the temperature set on the remote controller.



Remote Controller

Airflow Direction Control

Vertical and Horizontal airflow is automatically adjusted depending on the operation mode once the unit is turned on.

The direction of airflow can be adjusted to your own preferences by pressing the SWING button on the remote controller.

OPERATION MODE	AIRFLOW DIRECTION
COOLING, DRY	Horizontal
HEAT, FAN	Vertical

Vertical Airflow Control

Using the remote controller to set various angles, or adjusting the louvers to direct air flow in a specific vertical direction.

Swinging airflow

Press the **◆SWING** button once, and the vertical louver will swing up and down automatically.

Directed Airflow

Press the **◆SWING** button when the vertical louvers are at the preferred angle. The automatic swing will stop, and hold the set position.

Horizontal Airflow Control

Using the remote controller to set various angles, or adjusting the louvers to direct air flow in a specific horizontal direction.

Swinging airflow

Press the **◆SWING** button once, and the horizontal louver will swing left and right automatically.

Directed Airflow

Press the **◆SWING** button when the horizontal louvers are at the preferred angle. The automatic swing will stop, and hold the set position.

Notes:

- If your unit has motorized louver adjustment, do not adjust louvers manually. It can cause malfunction. If a malfunction occurs, turn off the unit, and shut off all power to the unit, then restore power.
- It is best to not allow the vertical louver to point downward for prolonged periods in COOL or DRY mode, to prevent condensed water from dripping.
- If the unit does not have four way airflow control function, you can adjust the horizontal louvers manually.



Remote Controller

Smart Mode

By pressing the SMART button, the unit will enter SMART mode (a fuzzy logic operation) whether the unit is ON or OFF. In this mode, the temperature and fan speed are automatically set based on the current room temperature.

Operation MODE and Temperature are determined by the indoor room temperature		
Heat Pump Models		
Indoor Temperature	Operation Mode	Target Temperature
70°F (21°C) or below	HEATING	72°F (22°C)
70°F~73°F (21°C~23°C) or below	FAN	
73°F~79°F (23°C~26°C)	DRY	Room temperature decrease 2°F after operating for 3 minutes
Over 79°F (26°C) or below	COOLING	79°F (26°C)
Cooling Only Models		
Indoor Temperature	Operation Mode	Target Temperature
73°F (23°C) or below	FAN	72°F (22°C)
73°F~79°F (23°C~26°C) or below	DRY	Room temperature decrease 2°F after operating for 3 minutes
Over 79°F (26°C)	COOLING	79°F (26°C)



- SMART button is inoperable in SUPER Mode.
- Press the MODE button to cancel SMART Mode.
- Temperature, airflow, and direction are controlled automatically in SMART mode. However, for the inverter you can adjust -7°~7° if you still feel uncomfortable.

What you can do in SMART Mode		
Your Comfort	Button	Adjustment
Uncomfortable because of amount of air flow.		Indoor fan speed alternates between Highest, High, Medium, Low, and Lowest each time this button is pressed.
Uncomfortable because of air flow direction		Press the desired SWING button once. The vertical adjustment louver will swing to alternate the air flow direction.
		Press the button again, and the swing will stop. For horizontal airflow direction, please refer to the previous page for details.



Remote Controller

Clock

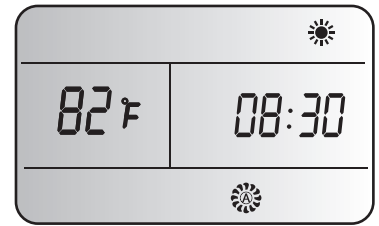

By Pressing the CLOCK button you can set the current time, and use the  and  buttons to adjust the clock. Press the CLOCK button again to set the time.



TIMER

The TIMER ON/ TIMER OFF allow you to set the start and stop time of your unit, so that your system can shut off when you are at out, or turn on before you return home.

Setting the TIMER ON

Press the TIMER ON button. The display will flash “ON 12:00” on the LCD display. You can adjust the start time by using the  and  buttons to the time you want your unit to start.







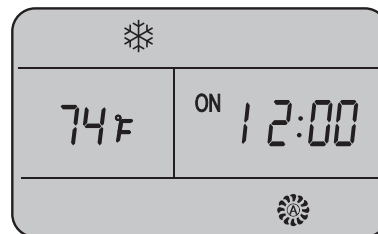

Increase



Decrease



- Press the  and  button once to increase or decrease the time setting by 1 minute.
- Press the  and  button 2 seconds to increase or decrease the time setting by 10 minutes.
- Press the  and  button and hold to increase or decrease the time setting by 1 hour.
- When your desired time is displayed on the LCD screen, press the TIMER ON button again to confirm it.
- A beep will sound, ON will stop flashing, and the TIMER ON indicator on the Indoor Unit will light up.
- After 5 seconds, the clock will resume displaying the current time on the remote control.

Note:

- If you do not set a time within 10 seconds of pressing the TIMER ON button, the remote will exit the TIMER ON function automatically.

Cancel TIMER ON

Press the TIMER ON button. A beep will sound and the indicator will disappear, indicating the TIMER ON mode has been cancelled.

TIMER OFF

The TIMER OFF setup, adjustment and cancel functions work the same way as described above, allowing you to automatically turn off your system at your set desired time.

Remote Controller

8° HEATING

- 8° HEAT mode can be set using this button. In 8° HEATING Mode, the fan speed is set to AUTO by default.
- Pressing any button except TIMER ON, TIMER OFF, CLOCK, IFEEL or SWING, you will cancel the 8° HEATING mode and resume normal operation. The 8° HEATING icon will no longer display on the remote controller LCD.

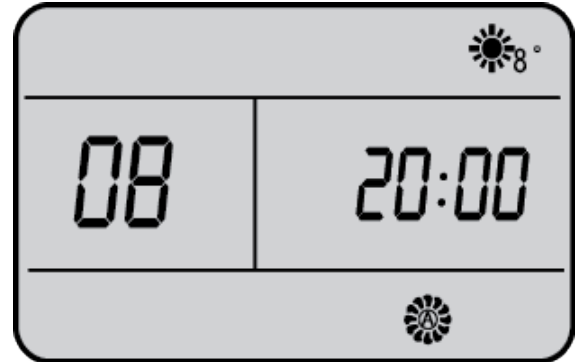

SUPER

- SUPER Mode is used to start or stop fast cooling or heating. In SUPER Mode, the Super icon will display on the remote controller LCD screen.
- SUPER Mode can be set when the air conditioner is turned on and running.
- In SUPER Mode, you can set the temperature, airflow direction, and timer.
- If you would like to turn off SUPER Mode, press the SUPER, MODE, FAN, ON/OFF or SLEEP buttons. The display will return to its normal mode.

Notes:

- SMART mode is not available in SUPER mode.
- The unit will stay in SUPER mode, until one of the buttons above is pressed.
- SUPER mode is not available while heating. It is available in COOLING only.
- For first generation units, you cannot set temperature in SUPER Mode, but you can press the increase or decrease temperature buttons to escape SUPER Mode



YMGI is dedicated to designing, manufacturing and distributing the highest quality, energy saving and environmentally friendly air conditioner and heat pump products, while providing the best service and support to all of our customers. Our mission is to help build a sustainable, efficient and green world.

YMGI Symphony-Ductless & Ducted Heat Pump & Heat Recovery:

- **Symphony SOLAR DC Inverter**
(55) Multiple PV, (56) Single PV; (78) Multiple PH; (79) Single PH
- **Symphony SOLO DC Inverter**
(57)2,3-Single Zone 16 SEER, 09-24K Btu/h
(58)2-Single Zone 16-22 SEER, 09-36K Btu/h
(58)3-Single Zone 21 SEER, 09-36K Btu/h
(58)4-Single Zone 30 SEER, 09-18K Btu/h
- **Symphony CHOIR DC Inverter**
(59)2-DC Inverter Multiple Zone 16 SEER, 2x09K to 5x12K Btu/h
(59)4-DC Inverter Multiple Zone 21 SEER, 2x09K to 5x12K Btu/h
(59)2S-DC Inverter Multiple Zone 16 SEER 6x09K to 9x09K Btu/h
- **Symphony VRF-DC Inverter HP or Heat Recovery up to 80 Zones.**
- **Symphony HARMONY-Packaged Self-Contained**
42"x16" PTAC/PTHP, 26" & 24" TTWA, and 37"x24" WMMP
- **Symphony CONDUCTOR**
Side Discharge Condensing Unit SHCR
Mini Central Packaged Unit VPAK

YMGI Group
601 Arrow Ln, O'Fallon, MO 63366
www.ymgigroup.com

YMGI HVAC & Solar Supply
601 Arrow Ln, O'Fallon, MO 63366
www.ymgihvacsupply.com

Tel: 866-833-3138 • Fax: 866-377-3355 • Email: info@YMGIgroup.com

Unit appearance and specifications are subject to change without notice.

Copyright ©2018 YMGI Group